

REVISIONS				
ZONE	REV.	DESCRIPTION	DATE	APPROVED
	A	NEW DRAWING/NTD 10179		

8X 22 AWG  
UL 3265; 125°C, 150V

LABEL PRINTED AS FOLLOWS:  
COMPANY NAME  
UNIT TYPE  
DATE CODE

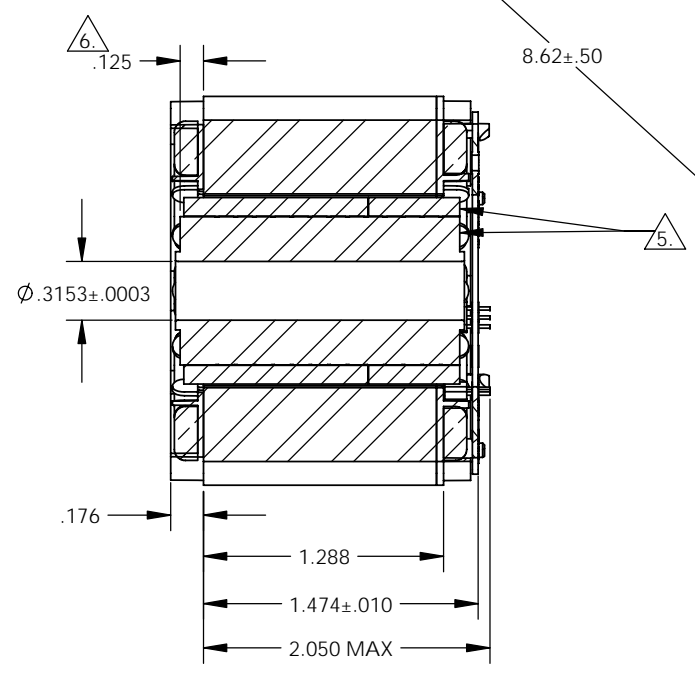

SECTION A-A

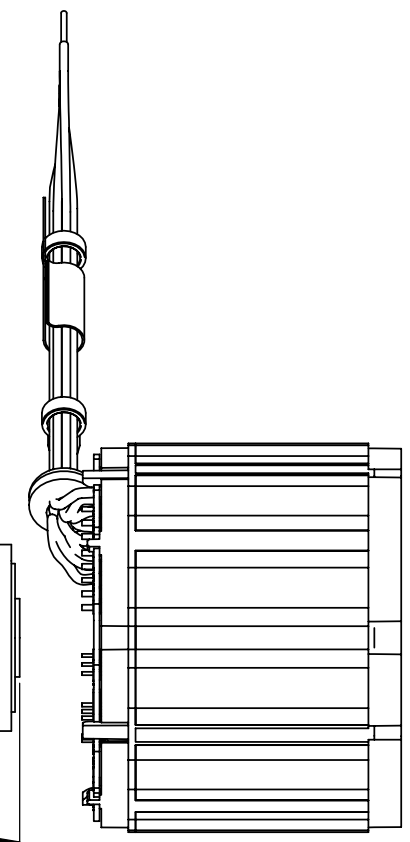
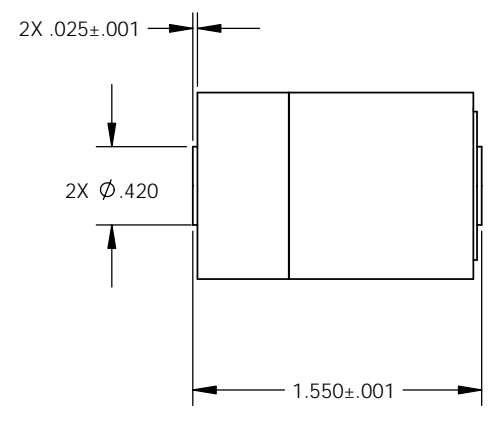
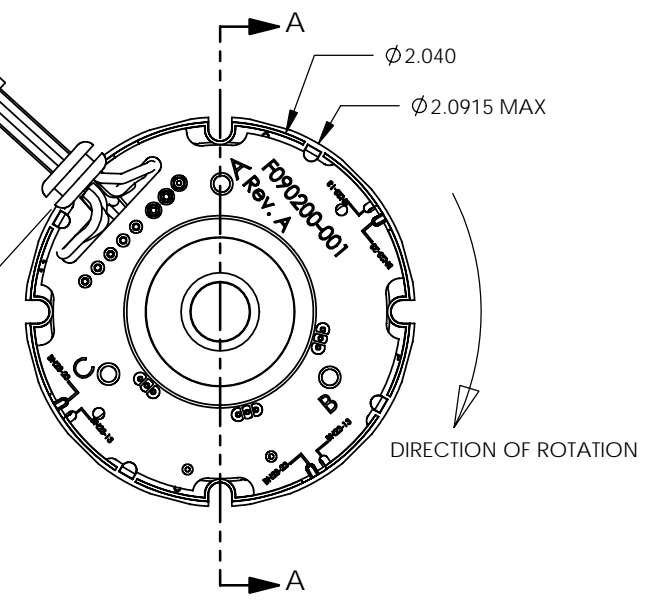

NOTES UNLESS OTHERWISE SPECIFIED:

1. INTERPRET DRAWING PER ASME Y14.100.
2. OPEN COLLECTOR OUTPUTS, USE PULL UP RESISTORS BETWEEN V<sub>CC</sub> AND OUTPUTS.
3. TESTED AS A MOTOR ASSEMBLY MOUNTED TO 6" X 6" X 1/4" ALUMINUM PLATE, STILL AIR.
4. MAXIMUM WINDING TEMPERATURE OF 155°C.
5. MAGNET RING AND ROTOR CORE: FLUSH ±.002 ON THIS SIDE.
6. RECOMENDED ROTOR CORE TO STACK MOUNTING DIMENSION.

TERMINATION TABLE	
COLOR	CONNECTION
VIOLET	A COIL
BLACK	B COIL
GREEN	C COIL
YELLOW	V <sub>CC</sub>
GREY	GROUND
BROWN	S1 OUT
BLUE	S2 OUT
WHITE	S3 OUT

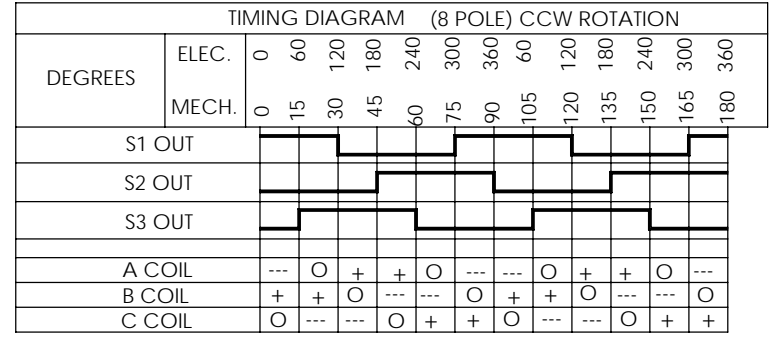

PERFORMANCE AT 25°C				
PARAMETER	SYMBOL	UNITS	TOLERANCE	VALUE
TERMINAL VOLTAGE	V	VOLTS DC	NOMINAL	36
PEAK TORQUE	T <sub>P</sub>	OZ-IN	MAXIMUM	143
CONTINUOUS STALL TORQUE	T <sub>C</sub> <sup>1</sup>	OZ-IN	MAXIMUM	44.7
NO LOAD SPEED	S <sub>NL</sub>	RPM	NOMINAL	8800
RATED SPEED	S <sub>R</sub>	RPM		6700
RATED TORQUE		OZ-IN	MAXIMUM	42.3
RATED CURRENT		AMPS		7.44
RATED POWER		WATTS		210
TORQUE SENSITIVITY	K <sub>T</sub>	OZ-IN/AMP	±10%	5.35
BEMF CONSTANT	K <sub>E</sub>	VOLTS/KRPM	±10%	3.96
TERMINAL RESISTANCE	R <sub>M</sub>	OHMS	±12%	0.347
TERMINAL INDUCTANCE	L <sub>M</sub>	mH	±30%	0.420
MOTOR CONSTANT	K <sub>M</sub>	OZ-IN/√ WATTS	NOMINAL	9.08
SPEED TORQUE GRADIENT		RPM/OZ-IN		49.60
MECHANICAL TIME CONSTANT		msec		2.60
ELECTRICAL TIME CONSTANT		msec		1.21
THERMAL RESISTIVITY		°C/WATT		1.89

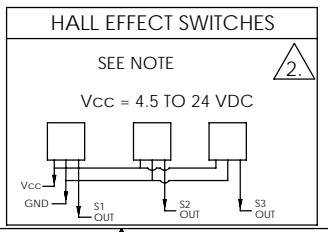

UNLESS OTHERWISE SPECIFIED DIMENSIONS ARE IN INCHES	CAD GENERATED DRAWING, DO NOT MANUALLY UPDATE	
	APPROVALS	DATE
TOLERANCES ARE:	DRAWN	R. PACE 1/31/06
DECIMALS .XX ±.010	CHECKED	R. MARTIN 2/10/06
.XXX ±.005	ENGR	D. THOMPSON 2/10/06
.XXXX ±.0005	RELEASED	R. MARTIN 2/14/06
ANGLES ±0°30'	MFG ENGR	L. FORRISTER 2/13/06
FRACTIONS ±1/64	SHOP ENGR	
DO NOT SCALE DRAWING	CA	B. LITTLE 2/10/06
MATERIAL		
FINISH		

**MOOG**  
COMPONENTS GROUP

TITLE: BRUSHLESS D.C. MOTOR OUTLINE

SIZE: C	CAGE CODE: 4H618	DWG. NO.: BN23-23ZMG-02LH
SCALE: 1.5:1	CAD FILE: BN23-23ZMG-02LH	SHEET 1 OF 1