

Brushless Limited Angle Torodial Motors

TD-1750-C SPECIFICATIONS @ 25°C

Size Constants	Value	Units
Peak Torque, T_P	12	oz-in
Motor Constant, K_M	1.48	oz-in/ \sqrt{W}
Excursion Angle	± 31	degrees
Number of Poles	4	
Weight	2.5	oz (nom)
Motor Inertia, J_M	6.60E-04	oz-in-s ²
Friction Torque, T_F	0.05	oz-in
Electrical Time Constant, τ_E	TBD	ms
Mechanical Time Constant, τ_M	36.54	ms
Winding Constants	Value	Units
Torque Sensitivity, K_T	4	oz-in/amp
Back EMF, K_E	0.028	V per rad/s
Terminal Resistance, R_M	6.2	ohms (nom)
Terminal Inductance, L_M	TBD	mH (nom)
Voltage, Stalled at Peak Torque, V_P	19	volts
Amps at Peak Torque, I_P	3	amps

TD-1750-C Typical Outline Drawing

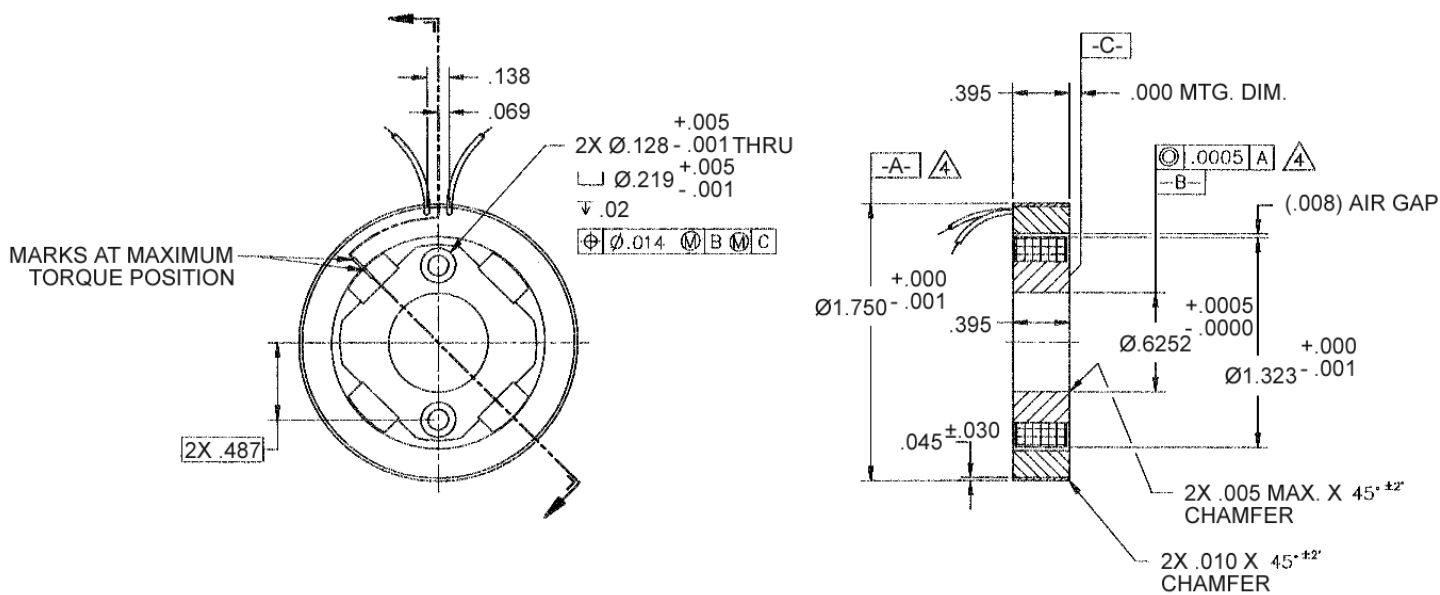

Dimensions are in inches