

# Miniature Slip Ring Capsules

## RE4815

*Miniature slip ring capsule in a compact configuration for demanding applications*

### Description

A slip ring capsule can be used in an electromechanical application to transfer low power and data over a continuous rotary interface, eliminating the need for wrapped cables. The RE4815 provides highly compact packaging to 32 conductors in a very small 1/2 inch diameter housing with an overall length of less than 1-3/8 inches.

### Features

- Compact for ease of incorporation in small mechanisms
- 32 rings with excellent signal handling properties as well as low power transfer
- Gold-on-gold contact technology
- Up to 600 rpm operation
- Low electrical noise

### Benefits

- Highly compact to keep mechanisms small
- Outstanding signal handling capability to transfer the most demanding communication protocols
- Proprietary plating techniques and materials for high performance and reliability
- Rugged stainless steel housing for demanding environments



### Typical Applications

- Gimble systems
- UAV camera systems
- Positioning tables
- Laboratory equipment

# Miniature Slip Ring Capsules

RE4815 Specifications	
Current Rating	1 A per circuit
Operational Voltage	50 VAC / VDC
Lead Size	30 AWG (19 / 42 SPC, Teflon® insulation)
Starting Torque	50 gm cm
Electrical Noise	50 milliohms maximum tested @ 6 VDC 50 milliamps when running @ 130 rpm
Operational Temperature	80°C maximum
Rotational Speed	600 rpm
Circuit Resistance	900 milliohms maximum
Enclosure	Stainless steel

Lead Color Codes							
1	BLK	9	GRY	17	WHT/BLU	25	WHT/BLK/BLU
2	BRN	10	WHT	18	WHT/VIO	26	WHT/BLK/VIO
3	RED	11	WHT/BLK	19	WHT/GRY	27	WHT/BLK/GRY
4	ORN	12	WHT/BRN	20	WHT/BLK/BRN	28	WHT/BRN/RED
5	YEL	13	WHT/RED	21	WHT/BLK/RED	29	WHT/BRN/ORN
6	GRN	14	WHT-ORN	22	WHT/BLK/ORN	30	WHT/BRN/YEL
7	BLU	15	WHT/YEL	23	WHT/BLK/YEL	31	WHT/BRN/GRN
8	VIO	16	WHT/GRN	24	WHT/BLK/GRN	32	WHT/BRN/BLU

## RE4815 Dimensions

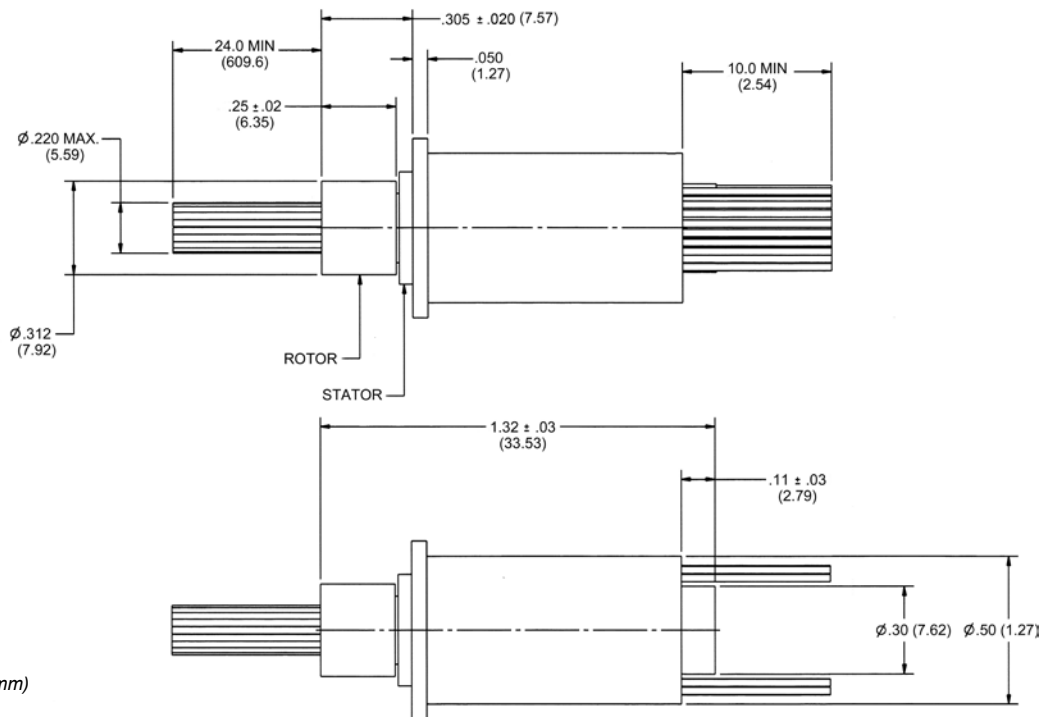

Dimensions in inches (mm)