

# TD-2500-F-1 Specifications

## TD-2500-F-1 SPECIFICATIONS @ 25°C

Size Constants	Value	Units
Peak Torque, $T_P$	18	oz-in
Motor Constant, $K_M$	2.35	oz-in/ $\sqrt{W}$
Excursion Angle	$\pm 60$	degrees
Number of Poles	2	
Weight	6.5	oz (nom)
Motor Inertia, $J_M$	2.30E-03	oz-in-s <sup>2</sup>
Friction Torque, $T_F$	0.3	oz-in
Electrical Time Constant, $\tau_E$	TBD	ms
Mechanical Time Constant, $\tau_M$	58.90	ms
Winding Constants	Value	Units
Torque Sensitivity, $K_T$	5.9	oz-in/amp
Back EMF, $K_E$	0.0417	V per rad/s
Terminal Resistance, $R_M$	6.3	ohms (nom)
Terminal Inductance, $L_M$	TBD	mH (nom)
Voltage, Stalled at Peak Torque, $V_P$	20	volts
Amps at Peak Torque, $I_P$	3.17	amps

Direct Drive  
Brushless Motors

### TD-2500-F-1 Typical Outline Drawing

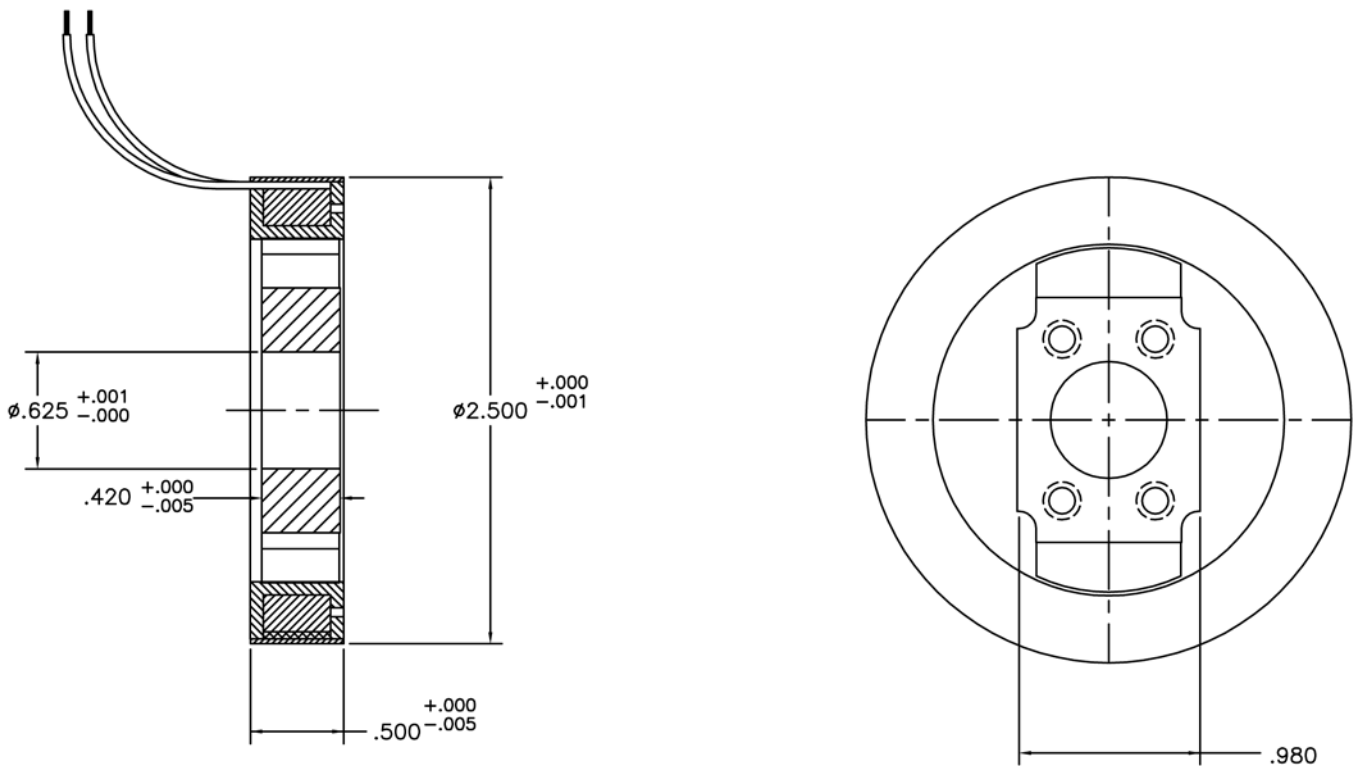

Dimensions are in inches